

I-IV-EG INVERTA® Instrument Tray

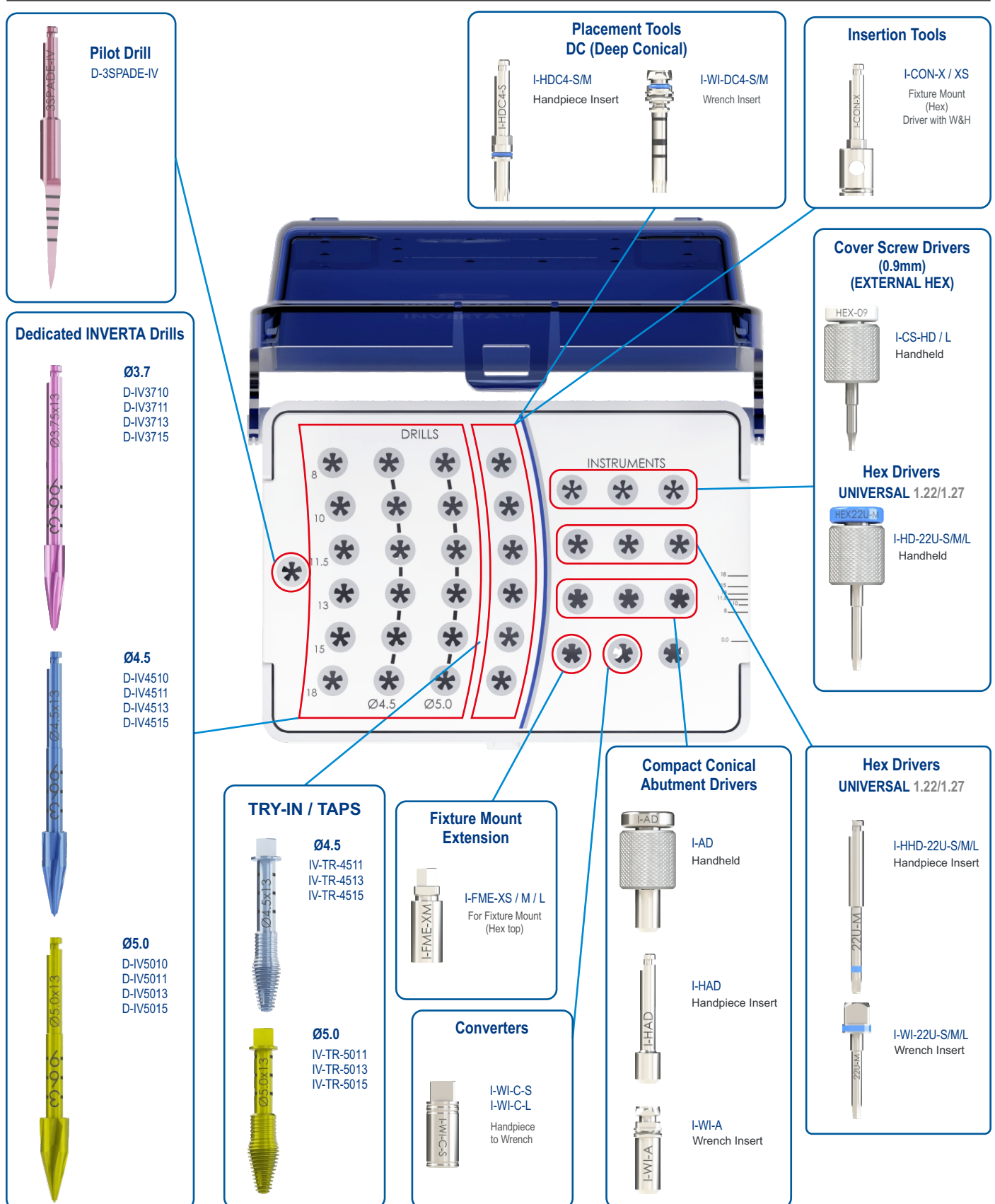

Images are for illustration purposes only and do not necessarily accurately represent the product. Not all products are cleared for sale in all countries.

SOUTHERNIMPLANTS.COM

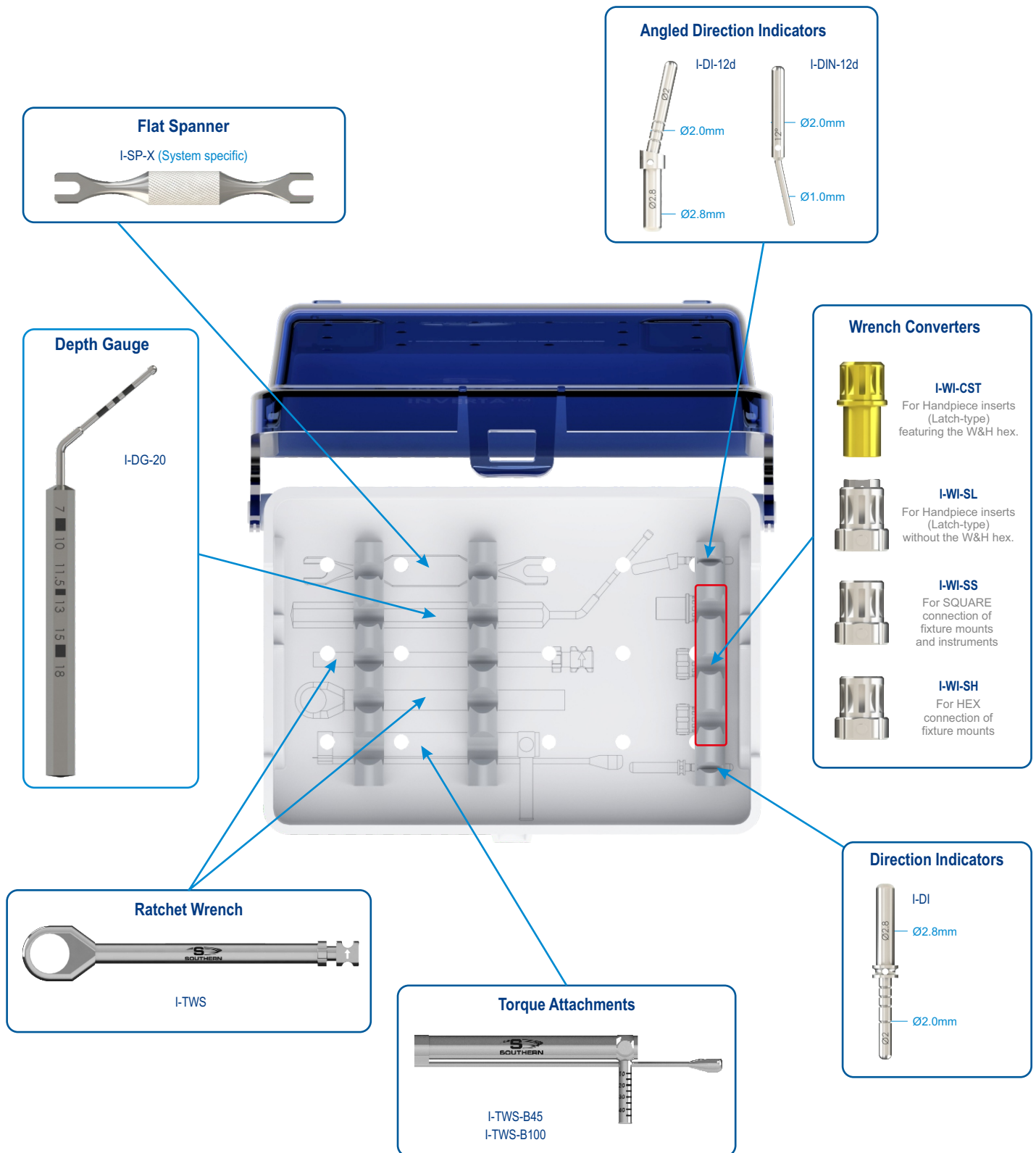

NOTE:

- The surgical kit has an intuitive layout to guide the surgeon through the drill sequence.
- Most Instruments available in Short / Medium / Long.
- All instruments and tooling used during the procedure must be maintained in good condition, and cleaned and sterilized prior to use. Please consult the Southern Implants Cleaning and Sterilization Procedure Guidelines (CAT-1039) for guidance concerning the maintenance of drills, instruments, and surgical trays.