

# IMPLANT RANGE

Product Code Breakdown

**IV-DC 35 12D-45 11**

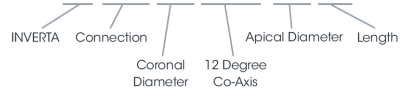

## Deep Conical (DC)

### Straight Connection

QTY	ITEM CODE	PROSTHETIC PLATFORM
—	IV-DC35-4008	Ø3.5/Ø4.0mm (DC4)
—	IV-DC35-4010	Ø3.5/Ø4.0mm (DC4)
—	IV-DC35-4011	Ø3.5/Ø4.0mm (DC4)
—	IV-DC35-4013	Ø3.5/Ø4.0mm (DC4)
—	IV-DC35-4015	Ø3.5/Ø4.0mm (DC4)
—	IV-DC40-5008	Ø3.5/Ø4.0mm (DC4)
—	IV-DC40-5010	Ø3.5/Ø4.0mm (DC4)
—	IV-DC40-5011	Ø3.5/Ø4.0mm (DC4)
—	IV-DC40-5013	Ø3.5/Ø4.0mm (DC4)
—	IV-DC40-5015	Ø3.5/Ø4.0mm (DC4)
—	IV-DC50-6010	Ø5.0mm (DC5)
—	IV-DC50-6011	Ø5.0mm (DC5)
—	IV-DC50-6013	Ø5.0mm (DC5)
—	IV-DC50-6015	Ø5.0mm (DC5)

### Co-Axis® Connection

QTY	ITEM CODE	PROSTHETIC PLATFORM
—	IV-DC3512D-4511	Ø3.5/Ø4.0mm (DC4)
—	IV-DC3512D-4513	Ø3.5/Ø4.0mm (DC4)
—	IV-DC3512D-4515	Ø3.5/Ø4.0mm (DC4)
—	IV-DC3512D-5011	Ø3.5/Ø4.0mm (DC4)
—	IV-DC3512D-5013	Ø3.5/Ø4.0mm (DC4)
—	IV-DC3512D-5015	Ø3.5/Ø4.0mm (DC4)

## External Hex

### Straight Connection

QTY	ITEM CODE	PROSTHETIC PLATFORM
—	IV-EX35-4510	Ø3.25mm (IBN)
—	IV-EX35-4511	Ø3.25mm (IBN)
—	IV-EX35-4513	Ø3.25mm (IBN)
—	IV-EX35-4515	Ø3.25mm (IBN)
—	IV-EX40-5010	Ø4.0mm (IB)
—	IV-EX40-5011	Ø4.0mm (IB)
—	IV-EX40-5013	Ø4.0mm (IB)
—	IV-EX40-5015	Ø4.0mm (IB)
—	IV-EX52-6010	Ø5.0mm (BA)
—	IV-EX52-6011	Ø5.0mm (BA)
—	IV-EX52-6013	Ø5.0mm (BA)
—	IV-EX52-6015	Ø5.0mm (BA)

### Co-Axis® Connection

QTY	ITEM CODE	PROSTHETIC PLATFORM
—	IV-EX3512D-4511	Ø3.25mm (IBN)
—	IV-EX3512D-4513	Ø3.25mm (IBN)
—	IV-EX3512D-4515	Ø3.25mm (IBN)
—	IV-EX4012D-5011	Ø3.25mm (IBN)
—	IV-EX4012D-5013	Ø3.25mm (IBN)
—	IV-EX4012D-5015	Ø3.25mm (IBN)
—	IV-EX5212D-6011	Ø5.0mm (BA)
—	IV-EX5212D-6013	Ø5.0mm (BA)
—	IV-EX5212D-6015	Ø5.0mm (BA)



Scan here  
to visit  
our  
website.

**S**  
**SOUTHERNIMPLANTS®**  
Innovative Treatment Solutions

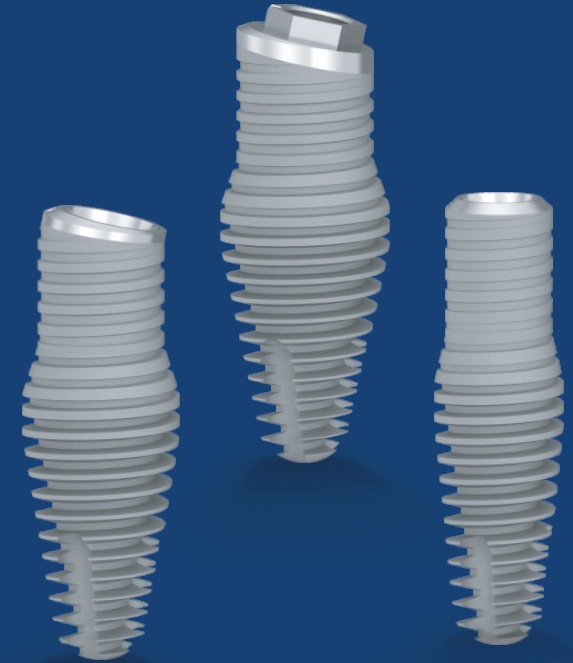

## CONTACT US

**South Africa - Headquarters**  
T: +27-12-667-1046 |  
E: info@southernimplants.com

**(Southern Implants Australia)**  
T: +61-(0)-8-9466-2627  
E: info@southernimplants.com.au

**(Spain and Portugal)**  
Southern Implants Iberica  
T: +34 935 053 507  
E: info@southernimplants.es

**(United Kingdom and Ireland)**  
Southern Implants UK  
T: +44-20-8899-6845 / 6 / 7  
E: info@southernimplants.co.uk

**(USA and Canada)**  
Southern Implants North America Inc.  
T: +1-561-472-0990  
E: customercare@southernimplants.com

For a full list of distributors and subsidiaries, please visit our website.

www.southernimplants.com

CAT-6040-00 (C1388)

# INVERTA®

Optimizing Predictable  
Anterior Aesthetics with an  
Innovative Body-Shift™  
Implant Design

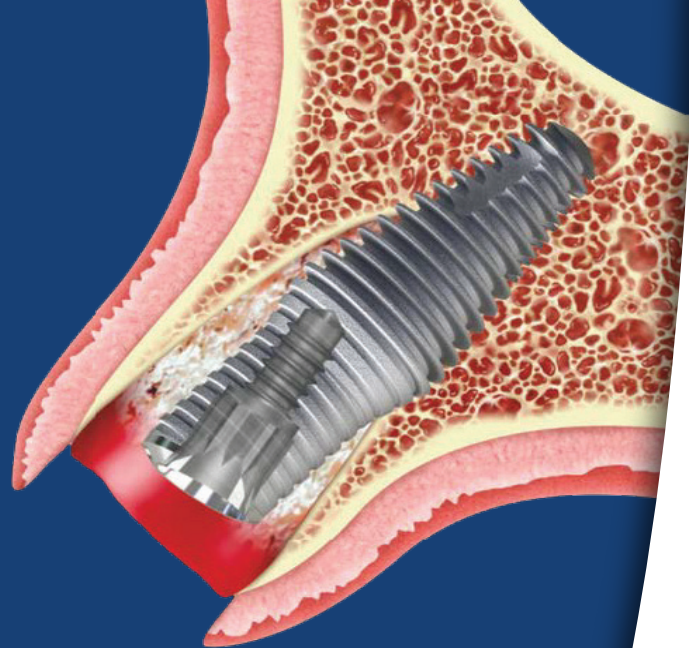

## Welcome to INVERTA® The latest Breakthrough Technology from Southern Implants®

The INVERTA® implant is a novel implant incorporating an innovative Body-Shift™ Design allowing for apical bone engagement in immediate implant placement and a coronal chamber for bone growth resulting in natural aesthetics.

### Popular Co-Axis® Feature

Built-in 12° Subcrestal Angle Correction® without using angled abutments resulting in greater facial soft-tissue volume and ideal screw-retained restorative options.

### Body-Shift Implant Design

Coronal aspect is narrow and tapers outward to a maximum diameter midway down the length of the implant. This innovative design allows for apical bone engagement in immediate placement and a coronal chamber for bone growth resulting in natural aesthetics.

### High Strength Titanium

Manufactured from High Strength Grade 4 Pure Titanium (≥900 MpA) providing exceptional fatigue strength.

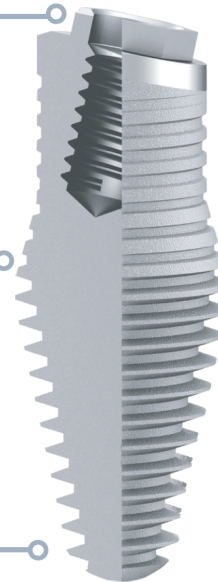

External  
Hex

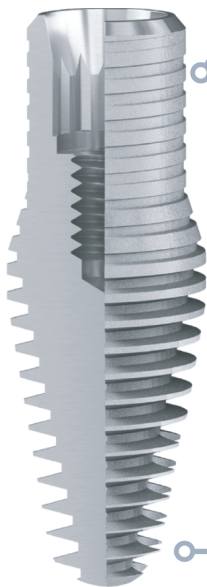

Deep Conical  
Connection

### Coronal Thread

All INVERTA® Implants feature a shallow square thread at the coronal aspect designed for blood clot and graft stability and thereafter the ability to effectively transfer load to the bone.

### Slnergy™ Surface with 20-Year History

Decades of clinical research back the un-changed, moderately rough Southern Implants Alumina-blasted surface shown to have consistent results for early osseointegration and longevity.

### Apical Thread

Aggressive thread for maximum primary stability in trabecular bone.

## Utilizing the INVERTA® Co-Axis® Implant to Achieve Predictable and Highly Aesthetic Outcomes

### Clinical Treatment By:

Stephen J. Chu, DMD, MSD, CDT and Dennis P. Tarnow, DDS



1. Patient presents with complaints of discoloration and hypermobility of #9 and #10. Radiograph shows signs of trauma and resorption.

2. Pre-operative condition of teeth #19 and #10. Note the thin periodontal phenotype, scalloped gingival architecture and mid-facial gingival recession.



3. PROVATA™ Implant placed at tooth #9 and INVERTA® Co-Axis® (12° Subcrestal Angle Correction ) Deep Conical Implant placed at tooth #10. Note the INVERTA® Implant does not impinge on the buccal wall.



4. The design of the mount for the INVERTA® Implant allows visualization of the screw access hole to be in the ideal restorative position.



5. Provisional restoration and CBCT at three-month follow-up.